

Design similar to
DIN 11851/EN 10357

USE:

Screw-type sight glasses are used to observe processes inside boilers, vessels and pipelines. They find application in the food sector, dairies, breweries, beverage industries and in pharmaceutical and medical technology. Due to the screw cap, quick cleaning of the sight glass is possible. The high permissible temperatures additionally enable sterilization.

INSTALLATION INSTRUCTIONS:

Ensure that the threaded socket is welded on without distortion! Welding work must be carried out by trained and authorized personnel.

OPERATING CONDITIONS

Temperature: (depending on glass and gasket)	≤ 200°C	Borosilicate glass (DIN 7080 or similar)
Pressure:	≤ 10 bar(g)	
Pressure with wiper:	≤ 6 bar(g)	

DRAWING:

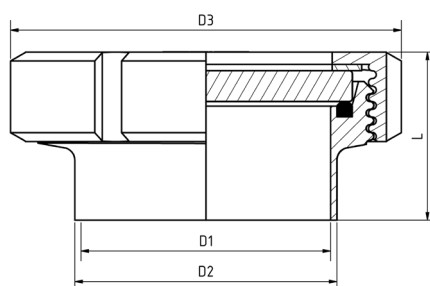

MATERIALS

Flange:	1.4404; 1.4301/7
Glass:	Borosilicate glass (DIN 7080 or similar)
Gasket: ¹	PTFE; FKM; NBR; Silicone; EPDM

1) See „INFO gaskets“ leaflet

DN	25	32	40	50	65	80	100	125	150
D1 [mm]	26	32	38	50	66	81	100	125	150
D2 [mm]	29	35	41	53	70	85	104	129	154
D3 [mm]	63	70	78	92	112	127	148	178	210
L [mm]	37	40	41	43	48	54	64	58	60
Wt. [kg]	0,31	0,40	0,50	0,70	1,10	1,61	2,27	3,10	5,30
Surface inside Ra ≤ 0,8 µm									

PRODUCT CODE:

Example to explain the code composition

11 - 327 - 100 - 1 - 1 - 1 - 000

GROUP	TYPE	NOMINAL SIZE	SOCKET/SLOTTED NUT ¹	GLASS	GASKET	VARIANT
11	327	DN 25	1) 1.4404	1) Borosilicate glass according to DIN 7080	1) PTFE	000) Standard
		DN 32	2) 1.4301/7	or similar	2) FKM	
		DN 40		3) Borosilicate glass ² + PTFE wiper SGW	3) NBR	
		DN 50		5) Borosilicate glass ² + Silicone wiper SGW	5) Silicone	
		DN 65			6) EPDM	
		DN 80			8) Special	
		DN 100				
		DN 125				
		DN 150				

1) Slotted nut according to quotation/order confirmation

2) Similar to DIN 7080



Unless otherwise stated, the highlighted factory standard is supplied.

EXAMPLE:

11-327-100-1-1-1-000 equivalent to:

ACI Type 327

DN 100

Socket made of 1.4404

Slotted nut made of 1.4404

Borosilicate glass DIN 7080

Gasket PTFE

Standard version:

- additional equipment optional

CONSTRUCTION:

Slotted nut

Gasket (on the atmosphere side)

Sight glass

D-ring gasket (on the media side)

Socket

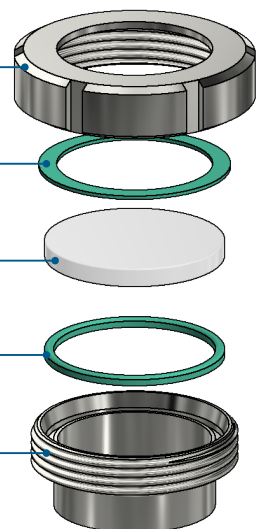

QUICK OVERVIEW:



PN 6/PN 10
6 up to 10 bar(g)



heat-resistant up to
200 °C



for liquid
media



for gaseous
media



Nominal size
DN 25 up to 150



Customized products
possible



Additional equipment
available

OPERATING CONDITIONS:

Operating conditions depend on the
choice of glass and gaskets:

		SIGHT GLASS	GASKETS				
		Borosilicate glass (DIN 7080 or similar)	PTFE max. 200 °C	FKM max. 200 °C	NBR max. 80 °C	Silicone max. 180 °C	EPDM max. 130 °C
TEMPERATURE	up to 80 °C	✓	✓	✓	✓	✓	✓
	up to 130 °C	✓	✓	✓	✗	✓	✓
	up to 150 °C	✓	✓	✓	✗	✓	✗
	up to 200 °C	✓	✓	✓	✗	✗	✗
PRESSURE	6 up to 10 bar(g)	✓	✓	✓	✓	✓	✓

✓ suitable ✗ unsuitable

OPTIONAL EQUIPMENT:



Wiper SGW

› with PTFE, Silicone, EPDM or FKM
wiper blade



LED light

› for Ex and non-Ex areas